

ORDINANCE 17- 27

AN ORDINANCE AMENDING TITLE 9 BUILDING REGULATIONS OF THE MUNICIPAL CODE ADDRESSING THE HISTORIC DISTRICT THROUGH LEGAL DESCRIPTION AND BOUNDARY MAP

WHEREAS, the Village of West Dundee, Kane County, Illinois, is a home rule municipality as contemplated under Article VII, Section 6 of the Constitution of the State of Illinois, and the passage of this Ordinance constitutes an exercise of the Village's home rule powers and functions as granted in the Constitution of the State of Illinois; and

WHEREAS, the President and Board of Trustees have reviewed existing West Dundee Historic District Legal Description and Map and considered that amending certain text and adding a boundary map to the West Dundee Municipal Code would be in the best interest of the Village; and

NOW, THEREFORE, BE IT ORDAINED by the President and Board of Trustees of the Village of West Dundee, Kane County, Illinois, as follows:

SECTION 1: That Title 9, Building of the Municipal Code, be amended per Exhibit A attached to this Ordinance.

SECTION 2: That Title 9, Building of the Municipal Code, be amended to include the West Dundee Historic District Boundary Map per Exhibit B attached to this Ordinance.

SECTION 3: If any section, paragraph, subdivision, clause, sentence, or provision of this Ordinance shall be adjudged in any Court of competent jurisdiction to be invalid, such judgment shall not effect, impair, invalidate or nullify the remainder thereof, which remainder shall remain in full force and effect.

SECTION 4: This ordinance shall be in full force and effect upon its passage, approval, and publication in pamphlet form which publications is hereby authorized as provided by law.

PASSED by the Board of Trustees of the Village of West Dundee, Kane County, Illinois, and approved by the President of said Village this 20th day of November, 2017.

AYES: Price, Hanley, Yuscka, Anderley, Wilbrandt and Kembitzky
NAYES: None

ATTEST:

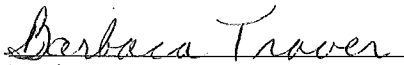
Barbara Traver
Village Clerk



Christopher Nelson
Village Presiden

EXHIBIT A

9-6-2: DEFINITIONS:

HISTORIC DISTRICT: That portion of the village of West Dundee legally described as follows:

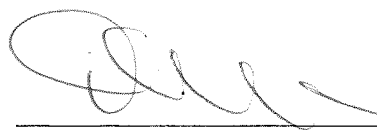
Beginning at the northwest corner of lot 5, block 8 of the Original Town of West Dundee (near the intersection of Route 72 and Route 31), thence in a southerly direction along the west line of said lot, approximately ~~150~~ 60 feet, thence in an easterly direction to the east line of said lot, approximately 60 feet, thence in a southerly direction along the east line of said lot approximately 90 feet to the southwest~~east~~ corner of said lot, thence in an easterly direction along the south line of the plat of the Original Town of West Dundee through blocks 8, 7, 6, 5, and 4 of said subdivision, approximately ~~1,620~~ 1,563 feet, to the southeast corner of lot 3, block 4 of the Original Town of West Dundee, thence in a northerly direction along the east line of said lot approximately 14 feet to the southwest corner of lot 2 in Erwin Schmidt's Subdivision, thence in an easterly direction along the south line of said lot, approximately 120 feet to the westerly right-of-way line of Third Street, thence continuing easterly across Third Street, approximately 60 feet to the west line of lot 5, block 3 of the Original Town of West Dundee, thence in a southerly direction, approximately 14 feet to the southwest corner of the said lot, thence in an easterly direction along the south line of the plat of the Original Town of West Dundee through blocks 3, 2, and 1, and along said line extended approximately 1,120 feet to a point approximately midway between the banks of the Fox River, thence in a northerly direction following a line located approximately midway between the banks of the Fox River approximately 600 feet, to a point where the approximated midpoint of the Fox River intersects with the westerly right of way line of First Street extended, thence in a southerly direction along said line approximately 200 feet, to the northeast corner of lot 1, block 14 of the original Town of West Dundee, thence in a westerly direction along the north line of lots 1, 2, 3, 4, and 5, block 14 of the Original Town of West Dundee approximately 300 feet to the easterly right-of-way line of Second Street, thence continuing in a westerly direction across Second Street, approximately 60 feet to the northeast corner of lot 1, block 13 of the Original Town of West Dundee, thence in a westerly direction along the north line of lots 1 and 2, block 13 of the Original Town of West Dundee approximately 120 feet, to the southeast corner of lot 8, block 13 of said subdivision, thence in a northerly direction along the east line of said lot line extended approximately 180 feet to the center line of Washington Street, thence in a westerly direction along the center line of Washington approximately 150 feet to its intersection with the center line of Third Street, thence in a southerly direction along the center line of Third Street approximately 180 feet, to the intersection of said center line of the northern line of lot 9 block 12 of the Original Town of West Dundee extended, thence in a westerly direction along said line extended and the north line of lots 9, 10, and 11, block 12 of the Original Town of West Dundee approximately 210 feet to the northwest corner of lot 11, block 12 of the Original Town of West Dundee, thence in a southerly direction along the west line of said lot, approximately 30 feet, to the northeast corner of lot 2, block 12 of the Original Town of West Dundee, thence in a westerly direction along the north line of said lot extended approximately 150 feet, to the center line of Fourth Street, thence in a northerly direction along the center line of Fourth Street approximately 210 feet to its intersection with the center line of Washington Street thence in a westerly direction along the center line of Washington Street approximately 360 feet, to its intersection with the center line of

Fifth Street thence in a southerly direction along the centerline of Fifth Street approximately 210 feet, to the point of intersection with the north line of lot 2, block 11 of the Original Town of West Dundee extended, thence in a westerly direction along said line extended approximately 150 feet to the northwest corner of lot 2, block 11 of said subdivision thence in a northerly direction along the east line of lot 11, block 11 of the Original Town of West Dundee, approximately 30 feet, to the northeast corner of said lot, thence in a westerly direction along the north lines of lots 11, 10, and 9, block 11 of the Original Town of West Dundee approximately 180 feet to the eastern right-of-way line of Sixth Street, thence continuing in a westerly direction across Sixth Street, approximately 60 feet to the northeast corner of lot 1, block 10 of the Original Town of West Dundee, thence in a westerly direction along the north lines of lot 1, 2, 3, 4, and 5, block 10 of the Original Town of West Dundee approximately 300 feet to the eastern right-of-way line of Seventh Street, thence continuing in a westerly direction across Seventh Street, approximately 60 feet to the northeast corner of lot 1, block 9 of the Original Town of West Dundee, thence in a westerly direction along the north lines of lots 1, 2, 3, 4, and 5, block 9 of the Original Town of West Dundee approximately 300 feet, to the northwest corner of lot 5, block 9 of the Original Town of West Dundee, thence in a southerly direction along the west line of said lot, approximately 150 feet to the northerly right-of-way line of Main Street, thence continuing southerly across Main Street approximately 80 feet to the point of beginning.

EXHIBIT B

West Dundee Historic District Boundary Map

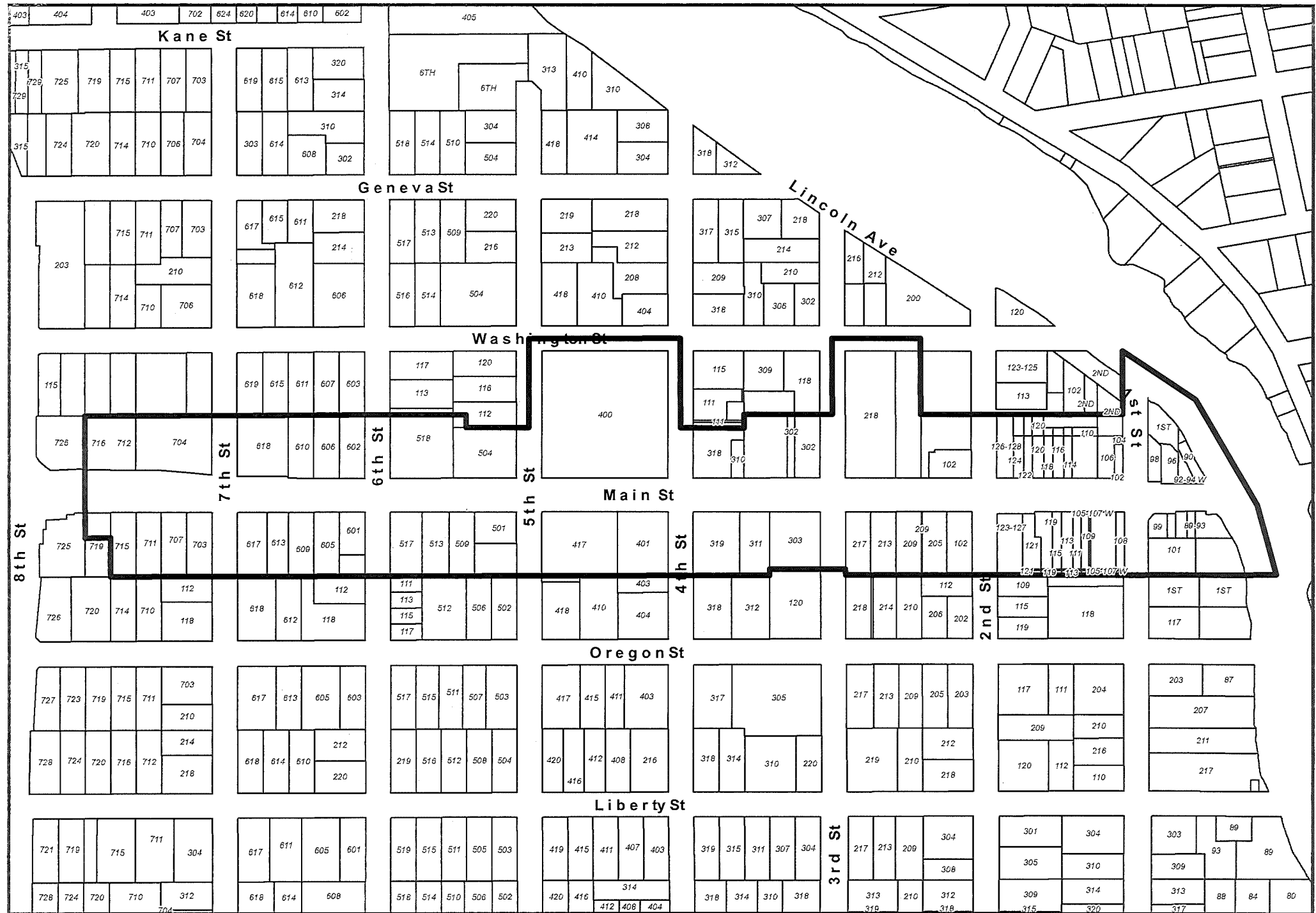

Sources: Village of West Dundee; Kane County GIS. Disclaimer: This map/data does not represent a survey. No accuracy is assumed for the data delineated herein, either expressed or implied by Kane County or its employees. This map is compiled from official records, including plats, surveys, recorded deeds, and contracts, and only contains information required for local government purposes. See the recorded documents for more detailed legal information.

0 100 200 Feet

N

West Dundee Historic District Boundary Map

West Dundee, IL 60118

 Village of
West Dundee
 Map Prepared: 11/1/2017