

Ordinance No. 14-02

**ORDINANCE APPROVING A PLAT OF DEDICATION FOR A PORTION OF MEIER STREET
IN THE VILLAGE OF EAST DUNDEE, ILLINOIS**

WHEREAS, the Village of East Dundee, Kane and Cook Counties, Illinois (the “Village”), is a home-rule municipality authorized by Article VII, Section 6(a) of the Constitution of the State of Illinois of 1970; and,

WHEREAS, in furtherance of development, it is necessary for the Village to widen Meier Street and to approve a Plat of Dedication to permit such improvements to Meier Street as hereinafter set forth.

NOW, THEREFORE, BE IT ORDAINED, by the President and Board of Trustees of the Village of East Dundee, Kane and Cook Counties, Illinois, that the Plat of Dedication prepared by Gerald L. Heinz & Associates, dated January 3, 2014, as attached to this Ordinance, is hereby approved, and the Village Clerk is hereby authorized to record said Plat with the Kane County Recorder.

This Ordinance shall be in full force and effect upon its adoption, approval and publication in pamphlet form as provided by law.

PASSED this 13 day of January, 2014, pursuant to a roll call vote as

follows:

AYES: Trustees Gorman, Lynam, Skilliearn, Selep and Wood

NAYS: Ø

ABSENT: Trustee Ruffulo

APPROVED:

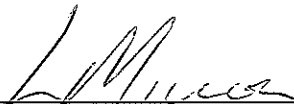

President

Attest:

Village Clerk

Alternatives

PLAT OF DEDICATION

IN THE VILLAGE OF EAST DUNDEE, ILLINOIS

BEING A PART OF THE SOUTHWEST QUARTER OF SECTION 23, TOWNSHIP 42 NORTH, RANGE 8, EAST OF THE THIRD PRINCIPAL MERIDIAN, IN THE VILLAGE OF EAST DUNDEE, KANE COUNTY, ILLINOIS.

LEGAL DESCRIPTION FOR RIGHT-OF-WAY DEDICATION (MEIER STREET)

THAT PART OF THE SOUTHWEST QUARTER OF SECTION 23, TOWNSHIP 42 NORTH, RANGE 8, EAST OF THE THIRD PRINCIPAL MERIDIAN DESCRIBED AS FOLLOWS:

BEGINNING AT A POINT ON THE SOUTHERLY LINE OF BARRINGTON AVENUE, 22.5 FEET WESTERLY OF MEASURED AT RIGHT ANGLES, THE CENTER LINE OF THE MAIN TRACK OF THE CHICAGO AND NORTH WESTERN RAILWAY COMPANY, AS NOW LOCATED AND ESTABLISHED; THENCE WESTERLY ALONG THE CENTER LINE OF SAID MAIN TRACK OF SAID RAILROAD COMPANY TO THE NORTHERLY LINE OF RAILROAD STREET; THENCE WESTERLY ALONG THE NORTHERLY LINE OF RAILROAD STREET, 49.5 FEET TO A POINT, 38 FEET WESTERLY OF MEASURED AT RIGHT ANGLES, THE EASTERLY LINE OF BLOCK 2 OF EDWARD'S ADDITION TO DUNDEE; THENCE NORTHERLY PARALLEL WITH THE EASTERLY LINE OF SAID BLOCK 2, 275 FEET TO THE SOUTHERLY LINE OF BARRINGTON AVENUE; THENCE EASTERLY ALONG THE SOUTHERLY LINE OF BARRINGTON AVENUE, 49.5 FEET TO THE POINT OF BEGINNING, IN THE VILLAGE OF EAST DUNDEE, KANE COUNTY, ILLINOIS.

TOTAL AREA OF DEDICATION 0.313 ACRES (MORE OR LESS).

COUNTY CLERK'S CERTIFICATE

STATE OF ILLINOIS }
COUNTY OF KANE } SS.

_____, COUNTY CLERK OF KANE COUNTY, ILLINOIS, DO HEREBY CERTIFY THAT THERE ARE NO DELINQUENT GENERAL TAXES, NO UNPAID FORFEITED TAXES, AND NO REDEEMABLE TAX SALES AGAINST ANY OF THE LAND INCLUDED IN THE PLAT HEREIN DRAWN. I FURTHER CERTIFY THAT I HAVE RECEIVED ALL STATUTORY FEES IN CONNECTION WITH THE PLAT HEREIN DRAWN.

GIVEN UNDER MY HAND AND SEAL AT GENEVA, KANE COUNTY, ILLINOIS, THIS ____ DAY OF _____, A.D. 2014.

COUNTY CLERK

KANE COUNTY RECORDER'S CERTIFICATE

STATE OF ILLINOIS }
COUNTY OF KANE } SS.

THIS INSTRUMENT NO. _____ WAS FILED FOR RECORD IN THE RECORDER'S OFFICE OF KANE COUNTY, ILLINOIS, ON THE ____ DAY OF _____, A.D. 20____ AT _____ O'CLOCK, ____M.

COUNTY RECORDER

CERTIFICATE OF DEDICATION APPROVAL

STATE OF ILLINOIS }
COUNTY OF KANE } SS.

THIS PLAT OF DEDICATION HAS BEEN APPROVED BY THE VILLAGE BOARD OF TRUSTEES OF THE VILLAGE OF EAST DUNDEE, ILLINOIS AT A MEETING HELD ON THIS ____ DAY OF _____, A.D. 2014.

VILLAGE PRESIDENT

VILLAGE CLERK

GERALD L. HEINZ & ASSOCIATES, INC.
CONSULTING ENGINEERS & LAND SURVEYORS
208 NORTH RIVER STREET
EAST DUNDEE, ILLINOIS 60118

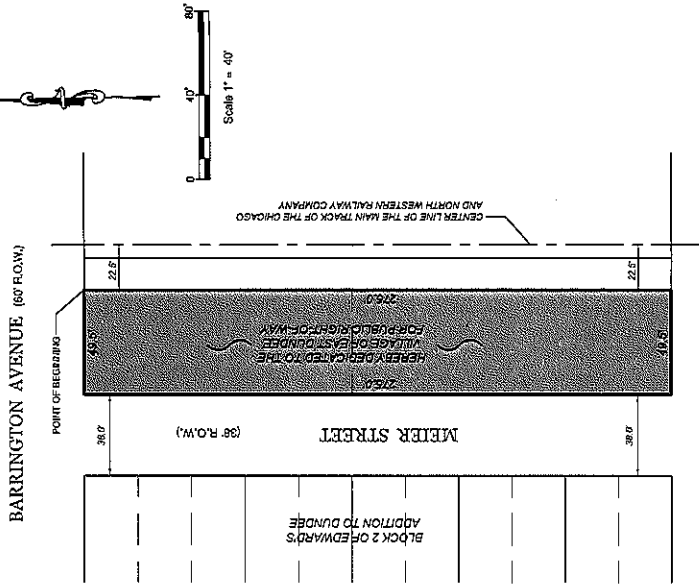

"OFFICIAL SEAL"
KATHERINE HOLT
NOTARY PUBLIC, STATE OF ILLINOIS
My Commission Expires 05/28/2017

SURVEYOR'S CERTIFICATE
STATE OF ILLINOIS }
COUNTY OF KANE } SS.

JOSEPH D. HEINZ, ILLINOIS PROFESSIONAL LAND SURVEYOR NO. 3551, DO HEREBY CERTIFY THAT THE PLAT HEREON DRAWN CORRECTLY REPRESENTS SAID SURVEY.



DATED AT EAST DUNDEE, ILLINOIS
THIS ____ DAY OF _____, 2014. A.D.

ILLINOIS PROFESSIONAL LAND SURVEYOR NO. 3551
LICENSE EXPIRES 11-30-14
DESIGN FIRM REGISTRATION NO. 184-002048

DATE:	01/08/14
JOB NO.:	ED-2000
SCALE:	1" = 40'
SHEET:	1 of 1

PLAT OF DEDICATION	MEIER STREET EAST DUNDEE, ILLINOIS
--------------------	---------------------------------------