

ORDINANCE NUMBER - 11-41
*An Ordinance Annexing Certain Property
Commonly Known as 14N963 Illinois Route 25
to the Village of East Dundee*

WHEREAS, a written petition, signed by the sole owner of record of all land within the territory hereinafter described, being identified as Pima Illinois, LLC (the "Petitioner"), has been filed with the Village of East Dundee Clerk requesting that said territory be annexed to the Village of East Dundee (the "Village") and the Petitioner has represented to the Village that there are no electors residing within the subject territory; and

WHEREAS, said territory is not within the corporate limits of any municipality, other than the County of Kane, and is contiguous to the corporate boundaries of the Village; and

WHEREAS, the Village provides neither a public library or fire protection; and

WHEREAS, all petitions, documents and other necessary legal requirements are in full compliance with the statutes of the State of Illinois, specifically 65 ILCS 5/7-1-1, *et seq.*; and

WHEREAS, it is in the best interests of the Village that said territory be annexed thereto.

NOW, THEREFORE, BE IT ORDAINED by the President and Board of Trustees of the Village of East Dundee as follows:

SECTION 1: The following legally described territory (the "Property") is hereby annexed to the Village of East Dundee:

Parcel One: The northerly half of that part of Sections 25, 26, 35 and 36, Township 42 north, Range 8 east of the Third Principal Meridian, described as follows: commencing at the southwest corner of Section 25; thence north along the west line of said Section 9.7 feet; thence westerly 124.15 feet on a line making an angle of 80 degrees, 51 minutes, 0 seconds to the northwest, with said west line of Section 25, to the center line of the Elgin and Dundee Road for a point of beginning; thence easterly along said last course, 380 feet on a line making an angle of 89 degrees, 58 minutes 0 seconds to the southeast with the centerline of the Elgin and Dundee Road; thence southerly parallel with the centerline of said road, 343.9 feet; thence westerly 380 feet on a line making an angle of 89 degrees, 58 minutes 0 seconds to the northwest with said center line to the center line of the Elgin and Dundee Road; thence northerly along the center line of said road, 343.9 feet to the point of beginning, in Dundee Township, Kane County, Illinois; and

Parcel Two: That part of the southwest quarter of Section 25, of the southeast quarter of Section 26 and of the northwest quarter of Section 36, all in Township 42 north, Range 8 east of the Third Principal Meridian, described as follows: commencing at

the southwest corner of the southwest quarter of said Section 25; thence north along the west line of said southwest quarter 9.7 feet; thence westerly along a line forming an angle of 80 degrees, 51 minutes, 0 seconds to the northwest with said west line, 124.15 feet to the center line of State Route 25 for the point of beginning; thence easterly along the last described course and said course extended on a line forming an angle of 89 degrees, 58 minutes, 0 seconds to the southeast with said center line 380 feet; thence southerly parallel with said center line, 171.95 feet; thence easterly along a line forming an angle of 89 degrees, 58 minutes 0 seconds to the southeast with said center line 370 feet; thence northerly parallel with said center line, 340.95 feet; thence westerly along a line forming an angle of 80 degrees, 51 minutes, 0 seconds to the northwest with the west line of the southwest quarter of Section 25, 750 feet to the center line of said State Route 25; thence southerly along said center line 169 feet to the point of beginning, in Dundee Township, Kane County, Illinois (together, the "Property").

SECTION 2: The Village of East Dundee Clerk is directed to record in the Office of the Recorder of Deeds and to file in the Office of the County Clerk of Kane County, Illinois, and the post office serving the Property within 30 days of the effective date of this Ordinance, a certified copy of this Ordinance, together with a plat or map of annexation of the Property hereby annexed.

SECTION 2: If any section, paragraph, subdivision, clause, sentence or provision of this Ordinance shall be adjudged by any Court of competent jurisdiction to be invalid, such judgment shall not affect, impair, invalidate or nullify the remainder thereof, which remainder shall remain and continue in full force and effect.

SECTION 3: All ordinances or parts of ordinances in conflict herewith are hereby repealed, to the extent of such conflict.

SECTION 4: This Ordinance shall be in full force and effect upon its passage, approval and publication in pamphlet form (which publication is hereby authorized) as provided by law.

Ayes: 6 - Justices Gorman, Lynam, Miller, VanOstenbidge, Skellicorn
‡ President Bartels

Nays: 0

Absent: 1 - Justice Ruffalo

Abstain: 0

APPROVED:



Village President Jerald Bartels

(SEAL)

ATTEST: Jennifer Rehberg
Village Clerk Jennifer Rehberg

Passed: September 19, 2011

Approved: September 19, 2011

Published: September 21, 2011

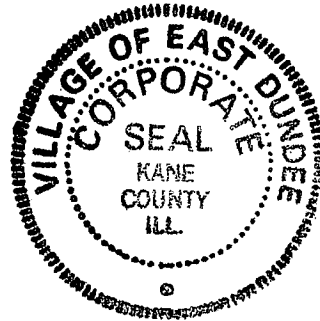

Prepared by/Mail to:
Michael J. Smoron
Zukowski Rogers Flood & McArdle
50 Virginia Street
Crystal Lake, IL 60014
815.459.2050
Z:\E\East Dundee\Pima Illinois LLC\Ordinance.annexation.doc

CERTIFICATION

I, JENNIFER REHBERG, do hereby certify that I am the duly appointed, acting and qualified Clerk of the Village of East Dundee, Kane County, Illinois, and that as such Clerk, I am the keeper of the records and minutes and proceedings of the President and Board of Trustees of said Village.

I do hereby further certify that at a regular meeting of the President and Board of Trustees of the Village of East Dundee, held on the 19th day of September, 2011, the foregoing Ordinance entitled *An Ordinance Annexing Certain Property Commonly Known as 14N963 Illinois Route 25 to the Village of East Dundee*, was duly passed by the President and Board of Trustees of the Village of East Dundee.

The pamphlet form of Ordinance No 11-41, including the Ordinance and a cover sheet thereof, was prepared, and a copy of such Ordinance was posted in the East Dundee Village Hall, 120 Barrington Avenue, East Dundee, IL, commencing on the 19th day of September, 2011, and continuing for at least 10 days thereafter. Copies of such Ordinance were also available for public inspection upon request in the office of the Village Clerk.

I do further certify that the original, of which the attached is a true and correct copy, is entrusted to me as the Clerk of said Village for safekeeping, and that I am the lawful custodian and keeper of the same.

IN WITNESS WHEREOF, I have affixed my name as Clerk and caused the seal of said Village to be affixed hereto this 19th day of September, 2011.

(SEAL)

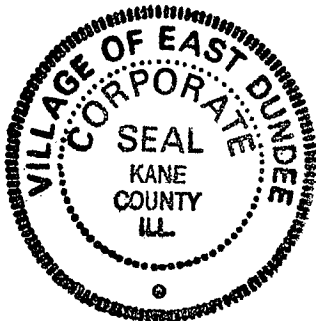

Jennifer Rehberg
Jennifer Rehberg, Village Clerk
Village of East Dundee,
Kane County, Illinois

MAP OF TERRITORY ANNEXED TO THE VILLAGE OF EAST DUNDEE, KANE COUNTY, ILLINOIS

BY ORDINANCE NO. _____ PASSED _____ 2011

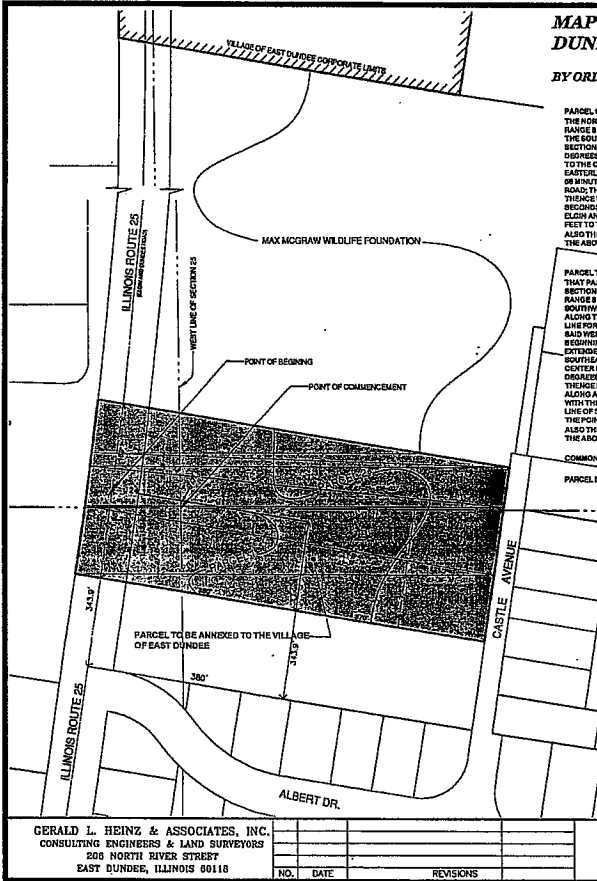

PARCEL ONE:
THE NORTHERLY HALF OF THAT PART OF SECTIONS 24, 26, 28 AND 30, TOWNSHIP 42 NORTH, RANGE 8 EAST OF THE THIRD PRINCIPAL MERIDIAN, DESCRIBED AS FOLLOWS: COMMENCING AT THE SOUTHWEST CORNER OF SECTION 28; THENCE NORTH ALONG THE WEST LINE OF SAID SECTION 27 FEET; THENCE WESTERLY 124.18 FEET ON A LINE MAKING AN ANGLE OF 89 DEGREES 51 MINUTES 0 SECONDS TO THE NORTHWEST, WITH SAID WEST LINE OF SECTION 28, TO THE CENTER LINE OF THE ELGIN AND DUNDEE ROAD FOR A POINT OF BEGINNING; THENCE EASTERLY ALONG SAID LAST COURSE, 180 FEET ON A LINE MAKING AN ANGLE OF 89 DEGREES 58 MINUTES 0 SECONDS TO THE SOUTHEAST WITH THE CENTER LINE OF SAID ROAD; THENCE SOUTHERLY PARALLEL WITH THE CENTER LINE OF SAID ROAD, 342.8 FEET; THENCE WESTERLY 289 FEET ON A LINE MAKING AN ANGLE OF 89 DEGREES 58 MINUTES 0 SECONDS TO THE NORTHWEST WITH SAID LAST CENTER LINE TO THE CENTER LINE OF THE ELGIN AND DUNDEE ROAD; THENCE NORTHWEST ALONG THE CENTER LINE OF SAID ROAD, 342.8 FEET TO THE POINT OF BEGINNING, IN THE TOWNSHIP OF DUNDEE, KANE COUNTY, ILLINOIS. ALSO THE WESTERLY 80 FEET HALF RIGHT OF WAY OF ELGIN AND DUNDEE ROAD ADJACENT TO THE ABOVE DESCRIBED PARCEL.

PARCEL TWO:
THAT PART OF THE SOUTHWEST QUARTER OF SECTION 24, OF THE SOUTHEAST QUARTER OF SECTION 28 SAID OF THE NORTHWEST QUARTER OF SECTION 16, ALL IN TOWNSHIP 42 NORTH, RANGE 8 EAST OF THE THIRD PRINCIPAL MERIDIAN, DESCRIBED AS FOLLOWS: COMMENCING AT SOUTHWEST CORNER OF THE SOUTHWEST QUARTER OF SAID SECTION 24; THENCE NORTH ALONG THE WEST LINE OF SAID SOUTHWEST QUARTER, 87 FEET; THENCE WESTERLY ALONG SAID WEST LINE, 126.18 FEET TO THE CENTER LINE OF STATE ROUTE 25, FOR THE POINT OF BEGINNING; THENCE WESTERLY ALONG THE LAST DESCRIBED COURSE 478 SAID COURSE EXTENDED ON A LINE FORMING AN ANGLE OF 89 DEGREES 58 MINUTES 0 SECONDS TO THE SOUTHEAST WITH SAID CENTER LINE, 80 FEET; THENCE SOUTHERLY PARALLEL WITH SAID CENTER LINE, 171.88 FEET; THENCE EASTERLY ALONG A LINE FORMING AN ANGLE OF 89 DEGREES 58 MINUTES 0 SECONDS TO THE SOUTHEAST WITH SAID CENTER LINE, 870 FEET; THENCE WESTERLY PARALLEL WITH SAID CENTER LINE, 342.8 FEET; THENCE WESTERLY ALONG A LINE FORMING AN ANGLE OF 89 DEGREES 51 MINUTES 0 SECONDS TO THE NORTHWEST WITH THE WEST LINE OF THE SOUTHWEST QUARTER OF SECTION 25, 792 FEET TO THE CENTER LINE OF SAID STATE ROUTE 25; THENCE SOUTHERLY ALONG SAID CENTER LINE, 180 FEET TO THE POINT OF BEGINNING, IN THE TOWNSHIP OF DUNDEE, KANE COUNTY, ILLINOIS. ALSO THE WESTERLY 80 FEET HALF RIGHT OF WAY OF ELGIN AND DUNDEE ROAD ADJACENT TO THE ABOVE DESCRIBED PARCEL.

COMMONLY KNOWN AS: 14NDKE3 ROUTE 25, EAST DUNDEE, IL 60118

PARCEL INDEX NUMBER:
03-23-300-003
03-28-074-01
03-25-027-001
03-28-101-001
03-26-101-002
03-28-101-003

STATE OF ILLINOIS
COUNTY OF KANE § 55
I, Jason D. Heinz, Licensed Professional Land Surveyor No. 3301, do hereby certify that the above is an accurate map of Territory annexed to the Village of East Dundee, by Ordinance No. _____ entitled "An Ordinance Annexing Certain Territory to Dundee Township, Kane County, Illinois, to the Village of East Dundee, 50th" passed by the Village of East Dundee on _____ 2011.

Dated at East Dundee, Illinois this _____ day of _____ 20____ A.D.

Jason D. Heinz
Professional Land Surveyor No. 3301
License Expires 11-20-2012
Design Firm Registration No. 194-022048



STATE OF ILLINOIS
COUNTY OF KANE § 55
This is to certify that this accurate map of Territory Annexed is identified as that incorporated 50th and 50th part of the Village of East Dundee Ordinance No. _____ of _____ 2011.

By: _____
Village President

This Map is Being Recorded By: _____
Name: _____
Address: _____

GERALD L. HEINZ & ASSOCIATES, INC.
CONSULTING ENGINEERS & LAND SURVEYORS
200 NORTH RIVER STREET
EAST DUNDEE, ILLINOIS 60118

NO.	DATE	REVISIONS

PLAN OF ANNEXATION
TORCO PROPERTY

VILLAGE OF EAST DUNDEE

DATE: 06/01/2011
JOB NO.: ED-186
SCALE: 1"=100'
SHEET 1 OF 1